

ISR & ISN SWAGING SERIES™

AMERICAN STANDARD RIVETNUTS • FOR BLIND HOLES OR LARGE GRIP RANGE

RIVETNUTS

The RivetKing ISN/ISR Series has the grip range that most rivetnuts lack. It has an unlimited maximum grip range which will work in all thickness above .030 (ISR Series) and .062 (ISN Series). The ISR series is designed for use in any metal, while the ISN series is designed for use in any material softer than itself such as plastics, fiberglass, and plywood.

ISR SWAGING SERIES™ STRAIGHT KNURL - FOR METALS

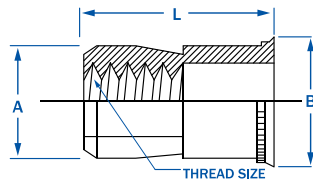

RECOMMENDED HOLE SIZE

PART CODE	THREAD SIZE	HEAD DIA +/- .005	LENGTH +/- .015	BODY DIA. MAX.	MATERIAL THICKNESS .030-.090	MATERIAL THICKNESS .091-.124	MATERIAL THICKNESS .125-.186	MATERIAL THICKNESS .187- OVER
4C1ISR	4-40 UNC	0.211	0.370	0.1875	0.1875	0.1935	0.1935	0.1960
6C1ISR	6-32 UNC	0.240	0.370	0.2185	0.2188	0.2210	0.2280	0.2280
8C1ISR	8-32 UNC	0.269	0.370	0.2495	0.2500	0.2570	0.2656	0.2656
10C1ISR	10-24 UNC	0.306	0.370	0.2805	0.2812	0.2900	0.2900	0.2969
10F1ISR	10-32 UNF	0.306	0.370	0.2805	0.2812	0.2900	0.2900	0.2969
25C1ISR	1/4-20 UNC	0.400	0.515	0.3745	0.3750	0.3750	0.3860	0.3906
31C1ISR	5/16-18 UNC	0.528	0.615	0.4995	0.5000	0.5000	0.5156	0.5156
37C1ISR	3/8-16 UNC	0.588	0.745	0.5165	0.5625	0.5625	0.5781	0.5781
50C1ISR	1/2-13 UNC	0.800	0.935	0.7485	0.7500	0.7656	0.7810	0.7970

ISN SWAGING SERIES™ DIAMOND KNURL - FOR PLASTICS / SOFT MATERIALS

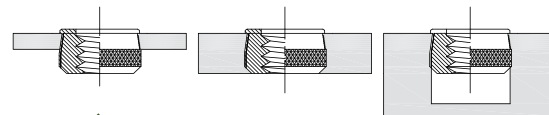
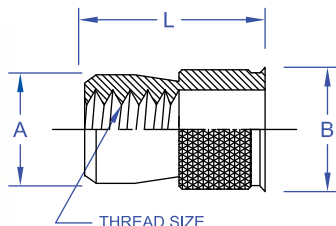

PART CODE	THREAD SIZE	HEAD DIA +/- .005	LENGTH +/- .015	BODY DIA MAX.	HOLE SIZE +.005/-.000	MATERIAL THICKNESS
6C1ISN	6-32 UNC	0.255	0.370	0.233	0.234	.062 MIN.
8C1ISN	8-32 UNC	0.285	0.370	0.264	0.266	.062 MIN.
10C1ISN	10-24 UNC	0.320	0.370	0.295	0.297	.062 MIN.
10F1ISN	10-32 UNF	0.320	0.370	0.295	0.297	.062 MIN.
25C1ISN	1/4-20 UNC	0.415	0.515	0.389	0.391	.062 MIN.
31C1ISN	5/16-18 UNC	0.550	0.615	0.528	0.531	.062 MIN.
37C1ISN	3/8-16 UNC	0.615	0.740	0.590	0.594	.062 MIN.

THE PART NUMBER IS COMPLETE BY ADDING THE MATERIAL AND FINISH CODES AS A SUFFIX TO THE PART CODE:

MATERIAL/FINISH CODES: SC1 = STEEL, CAD CLEAR PLATED
 SC2 = STEEL, CAD YELLOW PLATED
 ST = STEEL, TIN PLATED ROHS
 BP = BRASS, PLAIN FINISH

EXAMPLE:
 Part Code 6C1ISN in Steel,
 Tin ROHS Plating is... 6C1ISNST