



RivetKing® ABS-CT™ Series · "Crimp Style" · MultiGrip-CT™

RIVET: 5056 ALUMINUM • MANDREL: STEEL TRIVALENT ZINC PLATED

RIVET: ALUMINUM | MANDREL: STEEL TRIVALENT ZINC PLATED

The benefit of a MultiGrip™ is that they offer a wider grip range than traditional blind rivets assisting the users in inventory reduction and part consolidation efforts. The CT series has excellent hole fill ability and strength as compared to Standard Blind Rivets and RT series MultiGrips™. TS-16949 produced and when applicable on steel, trivalent zinc plated for ROHS and GMW3044 compliance.

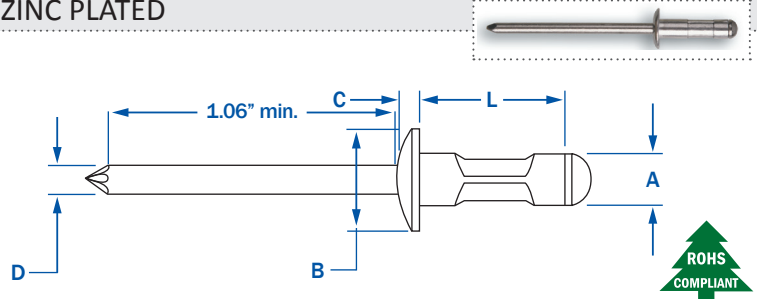

HEAD STYLE	PART NUMBER	A RIVET SIZE	L		B HEAD DIA NOM.	C HEAD HEIGHT NOM.	D MANDREL DIA NOM.	HOLE SIZE MIN. - MAX.	SHEAR TYPICAL LBS.F	TENSILE TYPICAL LBS.F
			GRIP RANGE MIN. - MAX.	LENGTH MAX						
DOME HEAD	ABS - 41 - 43MG	1/8"	.020 - .187	.315	.250	.037	.057	.129 - .138	165	230
	ABS - 42 - 44MG		.046 - .250	.375						
	ABS - 43 - 45MG		.156 - .312	.438						
	ABS - 45 - 46MG		.216 - .375	.500						
	ABS - 51 - 52MG	5/32"	.020 - .156	.270	.312	.047	.086	.161 - .169	255	375
	ABS - 52 - 54MG		.040 - .250	.375						
	ABS - 54 - 56MG		.156 - .375	.500						
	ABS - 56 - 58MG		.250 - .500	.666						
	ABS - 62 - 64MG	3/16"	.062 - .250	.406	.386	.057	.108	.192 - .200	350	530
	ABS - 63 - 67MG		.187 - .437	.595						
	ABS - 66 - 68MG		.250 - .500	.666						
	ABS - 68 - 610MG		.330 - .625	.760						
	ABS - 610 - 612MG		.500 - .750	.978						
	ABS - 82 - 84MG	1/4"	.062 - .250	.472	.511	.070	.141	.257 - .261	630	900
	ABS - 84 - 86MG		.156 - .375	.590						
ABS - 86 - 88MG	.250 - .750		.708							
LARGE FLANGE	ABS - 42 - 43LFMG	1/8"	.031 - .187	.315	.325	.039	.057	.129 - .138	165	230
	ABS - 42 - 44LFMG		.046 - .250	.375						
	ABS - 44 - 45LFMG		.156 - .312	.438						
	ABS - 52 - 54LFMG	5/32"	.062 - .250	.375	.375	.051	.086	.161 - .169	255	375
	ABS - 53 - 55LFMG		.125 - .312	.438						
	ABS - 55 - 58LFMG		.251 - .500	.690						
	ABS - 62 - 64LFMG	3/16"	.062 - .250	.406	.625	.069	.108	.192 - .200	350	530
	ABS - 66 - 68LFMG		.250 - .500	.666						
ABS - 610 - 612LFMG	.500 - .781		.978							
C'SUNK	ACS - 43 - 44MG	1/8"	.093 - .250	.383	.209	.029	.057	.129 - .138	165	230
	ACS - 53 - 55MG	5/32"	.110 - .312	.470	.252	.049	.086	.161 - .169	255	375
	ACS - 62 - 65MG	3/16"	.062 - .312	.500	.345	.051	.108	.192 - .200	350	530
	ACS - 66 - 68MG		.250 - .500	.690						

* 1/4" Diameter rivets have a 1.250 mandrel length minimum.

RivetKing® SBS-CT™ Series · "Crimp Style" · MultiGrip-CT™

STEEL/STEEL MULTIGRIP™ "CRIMP STYLE"

RIVET: STEEL TRIVALENT ZINC PLATED | MANDREL: STEEL TRIVALENT ZINC PLATED

The benefit of a MultiGrip™ is that they offer a wider grip range than traditional blind rivets assisting the users in inventory reduction and part consolidation efforts. The CT series has excellent hole fill ability and strength as compared to standard blind rivets and RT series MultiGrips™. TS-16949 produced and when applicable on steel, trivalent zinc plated for ROHS and GMW3044 compliance.

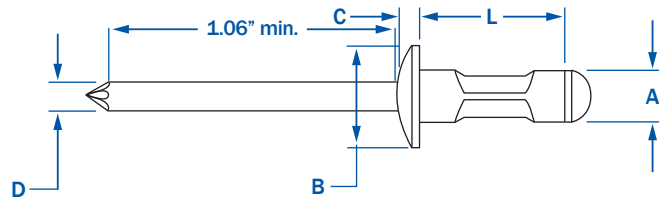

HEAD STYLE	PART NUMBER	RIVET SIZE	A		L		B	C	D	HOLE SIZE	SHEAR	TENSILE
			GRIP RANGE	LENGTH	HEAD DIA	HEAD HEIGHT						
			MIN - MAX	MAX	NOM.	NOM.	NOM.	NOM.	MIN - MAX	LBS.F	LBS.F	
DOME HEAD	SBS - 41 - 43MG	1/8"	.043 - .250	.355	.283	.033	.057	.129 - .133 (#30)	340	385		
	SBS - 42 - 44MG		.125 - .250	.407								
	SBS - 52 - 53MG	5/32"	.056 - .196	.433	.319	.047	.108	.160 - .164 (#20)	440	530		
	SBS - 62 - 63MG	3/16"	.062 - .187	.405	.386	.069	.133	.192 - .196 (#11)	450	787		
SBS - 63 - 64MG	.125 - .250		.511									

RivetKing® QuikSnap®

NICKEL PLATED BRASS HEAD | STAINLESS MANDREL - SPECIAL NOSE PIECE REQUIRED

The innovative RivetKing® Quik-Snap™ is the ideal companion to the standard canvas snap used on truck bodies, convertibles, boats, cars and many other applications. The snap head is brass, with a bright nickel plating. The mandrel is stainless steel. Requires T105-734 Nosepiece.

The extract force is a minimum of 5 lbs.

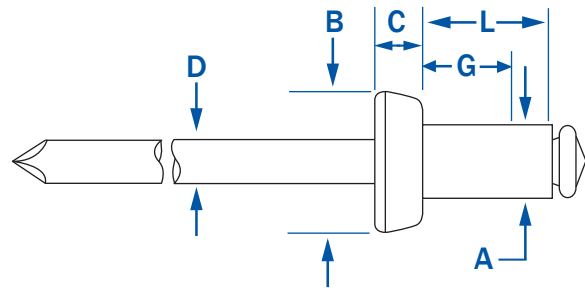

RIVET SIZE	A		D	B	C	L	PART NUMBER	G	TYPICAL ULTIMATE STRENGTH		CARTON	
	HOLE SIZE AND DRILL NO.	MANDREL DIA.							FLANGE DIA.	HEAD HEIGHT	BARREL LENGTH	GRIP RANGE
1/8"	.129-.133	.076	.395	.170	.337	B/SS43SH	.020-.087	.260	.310	10	43	
3.2	#30				.525	B/SS46SH	.188-.375			10	49	