

AVAILABLE IN STEEL, ALUMINUM, AND STAINLESS STEEL | COMPLIANT WITH IFI 134

*\*Any nose piece can be used. No special requirement.*

The RivetKing® In-Lock® is a structural rivet with an internal locking feature. The locking feature is not visible when the rivet is applied. The mandrel is retained within the shear plane yielding high strength under shear loads and the internal lock insures positive mandrel retention which results in high strength under pullout loads. Typically used in the manufacturing or repair of truck bodies, the In-Lock® is leak resistant and has excellent clamp-up force. The In-Lock® has a wide grip range and is offered in two diameters and two lengths. The mandrel breaks flush with the head when applied and is set without a special nose piece.

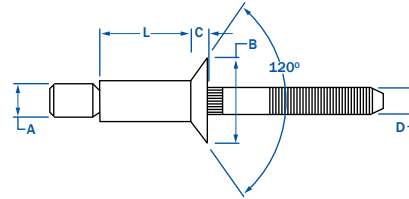
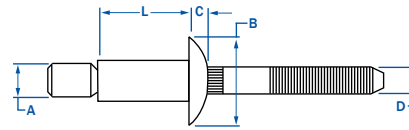

Material	PART NUMBER	RIVET SIZE	A		Head Style	L		B	C	D	HOLE SIZE	SHEAR	TENSILE	MANDREL PUSHOUT
			GRIP RANGE	MIN. - MAX.		LENGTH	HEAD DIA.							
ALUMINUM	ABA - 64 - STR	3/16"	.062 - .270		Dome	.415	.385	.085	.118	.191 - .201 (#10)	550	450	50	
	ABA - 67 - STR		.214 - .437	Dome	.572									
	ABA - 67E - STR		.062 - .437	Dome	.572									
	ABA - 86 - STR	1/4"	.080 - .375		Dome	.560	.525	.117	.157	.261 - .272 (G)	1270	830	100	
	ABA - 810 - STR		.350 - .625	Dome	.810									
	ABA - 810E - STR		.080 - .625	Dome	.810									
	ACA - 88 - STR	3/8" <b>NEW!</b>	.160 - .475		C'sunk	.660	.405	.070 Ref	.157	.392 - .408	2950	1900	250	
	ABA - 1212 - STR		.120 - .560	Dome	.843	.770	.177 MAX	.232						
STEEL	SBS - 64 - STR	3/16"	.062 - .270		Dome	.415	.385	.085	.118	.194 - .204 (#10)	1300	1000	150	
	SBS - 67 - STR		.214 - .437	Dome	.572									
	SBS - 67E - STR		.062 - .437	Dome	.572									
	SBS - 86 - STR	1/4"	.080 - .375		Dome	.560	.525	.117	.157	.261 - .276 (G)	2400	1850	300	
	SBS - 810 - STR		.350 - .625	Dome	.810									
	SBS - 810E - STR		.080 - .625	Dome	.810									
	SCS - 88 - STR	3/8" <b>NEW!</b>	.160 - .475		C'sunk	.660	.405	.070 Ref	.157	.392 - .408	5600	4000	650	
	SBS - 1212 - STR		.120 - .560	Dome	.843	.770	.177 MAX	.232						
STAINLESS	FBF - 64 - STR	3/16"	.062 - .270		Dome	.415	.385	.090	.118	.194 - .204 (#10)	1300	1000	100	
	FBF - 67 - STR		.214 - .437	Dome	.572									
	FBF - 67E - STR		.062 - .437	Dome	.572									
	FBF - 86 - STR	1/4"	.080 - .375		Dome	.560	.525	.117	.157	.261 - .276 (G)	2400	1850	200	
	FBF - 810 - STR		.350 - .625	Dome	.810									
	FBF - 810E - STR		.080 - .625	Dome	.810									
	FCF - 88 - STR	3/8"	.160 - .475		C'sunk	.660	.405	.070 Ref	.157					