

AVAILABLE MATERIALS: ALL STEEL, ALL ALUMINUM DOME HEAD

The Stemlock® is an advanced structural fastening solution that has among the highest shear and tensile values available because the mandrel is locked into the shear plane. The internal locking mechanism insures positive mandrel retention and will break flush with the head. The Stemlock® is designed to form a bearing surface flange at the rear side of the substrate. This rear flange is perfect for thin sheets or imperfect holes offering impressive clamp up forces without deforming the substrate.

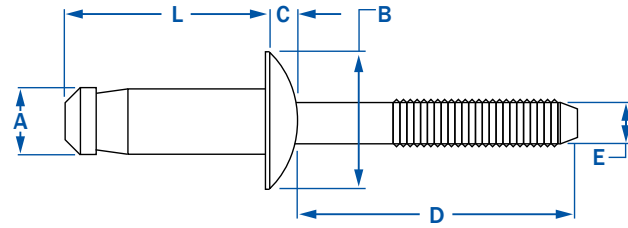

A		STANDARD FLANGE							BACKSIDE CLEARANCE	SHEAR STRENGTH	TENSILE STRENGTH
		L	A	B	C	E					
RIVET SIZE	PART NUMBER	GRIP RANGE	RIVET LENGTH	BODY	HEAD DIA.	HEAD HEIGHT	MANDREL DIA.	MIN.	LBF	LBF	
		MIN. - MAX.	MAX	DIA.	MAX.	MAX.	DIA.				
1/4"	STMS-0812	.068 - .138	.539	.250 .260	.530	.110	N/R	.480	2360	1,978	
	STMS-0813	.110 - .189	.590						2698		
	STMS-0814	.132 - .211	.612						2810		
	STMS-0815	.189 - .268	.669						3147		
	STMS-0817	.268 - .346	.747						3374		
	STMS-0818	.295 - .374	.775						3597		
	STMS-0819	.346 - .425	.826								
	STMS-0821	.425 - .504	.905								
1/4"	STMA-0812	.068 - .138	.539	.250 .260	.530	.110	N/R	.480	1124	600	
	STMA-0813	.110 - .189	.590						1349		
	STMA-0814	.132 - .211	.612						1394		
	STMA-0815	.189 - .268	.669						1460		
	STMA-0817	.268 - .346	.747						1574		
	STMA-0818	.295 - .374	.775								
	STMA-0819	.346 - .425	.826								
	STMA-0821	.425 - .504	.905								